

TECHNICAL MANUAL

ORGANIZATIONAL MAINTENANCE REPAIR PARTS

AND SPECIAL TOOLS LIST

FOR

RECEIVING SET, RADAR DATA AN/TKQ-2B
(NSN 5840-01-077-5723)

**ORGANIZATIONAL MAINTENANCE REPAIR PARTS
AND SPECIAL TOOLS LIST
FOR
RECEIVING SET, RADAR DATA ANITKQ-2B
(NSN 5840-01-077-5723)**

Current as of 20 October 1980

REPORTING ERRORS AND RECOMMENDING IMPROVEMENTS

You can help improve this manual. If you find any mistakes or if you know of a way to improve the procedures, please let us know. Mail your letter, DA Form 2028 (Recommended Changes to Publications and Blank Forms), or DA Form 2028-2 located in back of this manual direct to: Commander, US Army Communications and Electronics Materiel Readiness Command, ATTN: DRSEL-ME-MQ, Fort Monmouth, NJ 07703.

In either case, a reply will furnished direct to you.

TABLE of CONTENTS

		Page	Illus. Figure
SECTION	I. Introduction	1	
	II. Repair Parts List	5	
GROUP	00 Receiving Set, Radar Data AN/TKQ-2B	5	1
	01 Radio Set AN/ARC-164(V)12 (See TM 11-5841-286-20P for parts).....	7	2
	03 Shelter Electrical Assembly S-606/TKQ-2B		
	Shelter Cabinet Installation	9	35
	Shelter Cabinet Top Rack Detail	11	36
	Shelter Cabinet Middle Rack Detail	13	37
	Shelter Cabinet Lower Rack Detail	15	38
	Shelter Recorder-Processor-Viewer Rack Detail	17	39
SECTION	III. Special Tools List (Not applicable)		
	IV. National Stock Number and Part Number Index	18	

**SECTION I
INTRODUCTION**

1. Scope

This manual lists spares and repair parts; special tools; special test, measurement, and diagnostic equipment (TMDE), and other special support equipment required for performance of organizational maintenance of the AN/TKQ-2B. It authorizes the requisitioning and issue of spares and repair parts as indicated by the source and maintenance codes.

2. General

This Repair Parts and Special Tools List is divided into the following sections:

a. *Section II. Repair Parts List.* A list of spares and repair parts authorized for use in the performance of maintenance. The list also includes parts which must be removed for replacement of the authorized parts. Parts lists are composed of functional groups in numeric sequence, with the parts in each group listed in figure and item number sequence.

b. *Section III. Special Tools List.* Not applicable.

c. *Section IV. National Stock Number and Part Number Index.* A list, in National item identification number (NIIN) sequence, of all National stock numbers (NSN) appearing in the listings, followed by a list, in alphameric sequence, of all part numbers appearing in the listings. National stock numbers and part numbers are cross-referenced to each illustration figure and item number appearance.

3. Explanation of Columns

a. *Illustration.* This column is divided as follows:

(1) *Figure number.* Indicates the figure number of the illustration on which the item is shown.

(2) *Item number.* The number used to identify item called out in the illustration.

b. *Source, Maintenance, and Recoverability (SMR) Codes.*

(1) *Source code.* Source codes indicate the manner of acquiring support items for maintenance, repair, or overhaul of end items. Source codes are entered in the first and second positions of the Uniform SMR code format as follows:

<i>Code</i>	<i>Definition</i>
PA	Item procured and stocked for anticipated or known usage.
XD	A support item that is not stocked. When required, item will be procured through normal supply channels.

NOTE

Cannibalization or salvage may be used as a source of supply for any items source coded above except those coded XA and aircraft support items as restricted by AR 700-42.

(2) *Maintenance code.* Maintenance codes are assigned to indicate the levels of maintenance authorized to USE and REPAIR support items. The maintenance codes are entered in the third and fourth positions of the Uniform SMR Code format as follows:

(a) The maintenance code entered in the third position will indicate the lowest maintenance level authorized to remove, replace, and use the support item. The maintenance code entered in the third position will indicate one of the following levels of maintenance:

<i>Code</i>	<i>Application/Explanation</i>
O	Support item is removed, replaced, used at the organizational level.

(b) The maintenance code entered in the fourth position indicates whether the item is to be repaired and identifies the lowest maintenance level with the capability to perform complete repair (i.e., all authorized maintenance functions). This position will contain one of the following maintenance codes:

<i>Code</i>	<i>Application/Explanation</i>
D	The lowest maintenance level capable of complete repair of the support item is the depot level.
Z	Nonreparable. No repair is authorized.

(3) *Recoverability code.* Recoverability codes are assigned to support items to indicate the disposition action on unserviceable items. The recoverability code is entered in the fifth position of the Uniform SMR Code format as follows:

<i>Recoverability codes</i>	<i>Definition</i>
Z	Nonreparable item. When unserviceable, condemn and dispose at the level indicated in position 3.
D	Reparable item. When beyond lower level repair capability, return to depot. Condemnation and disposal not authorized below depot level.

c. *National Stock Number.* Indicates the National stock number assigned to the item and will be used for requisitioning purposes.

d. *Part Number.* Indicates the primary number used by the manufacturer (individual, company, firm, corporation, or Government activity), which controls the

design and characteristics of the item by means of its engineering drawings, specifications, standards, and inspection requirements to identify an item or range of items.

NOTE

When a stock numbered item is requisitioned, the repair part received may have a different part number than the part being replaced.

e. Federal Supply Code for Manufacturer (FSCM). The FSCM is a 5-digit numeric code listed in SB-41/42 which is used to identify the manufacturer, distributor, or Government agency, etc.

f. Description. Indicates the Federal item name and, if required, a minimum description to identify the item.

g. Unit of Measure (U/M). Indicates the standard of the basic quantity of the listed item as used in performing the actual maintenance function. This measure is expressed by a two-character alphabetical abbreviation (e.g., ea, in, pr, etc.). When the unit of measure differs from the unit of issue, the lowest unit of issue that will satisfy the required units of measure will be requisitioned.

h. Quantity Incorporated in Unit. Indicates the quantity of the item used in the breakout shown on the illustration figure, which is prepared for a functional group, subfunctional group, or an assembly.

4. Special Information

a. The following publications pertain to the AN/TKQ-2B and its components:

TM 11-5840-361-12, Receiving Set, Radar Data AN/TKQ-2B

TM 11-5841-286-13, Radio Set AN/ARC-164(V)12

TM 11-5841-286-20P, Radio Set AN/ARC-164(V)12.

b. The illustrations in this manual are identical to

those published in TM 11-5840-361-30P. Only those parts assigned the third position SMR maintenance code "C" or "O" are listed in the tabular listing; therefore, there may be a break in the item number sequence. Only illustrations containing organizational authorized items appear in this manual.

5. How to Locate Repair Parts

a. When National stock number or part number is unknown.

(1) First. Using the table of contents, determine the functional group within which the item belongs. This is necessary since illustrations are prepared for functional groups and listings are divided into the same groups.

(2) Second. Find the illustration covering the functional group to which the item belongs.

(3) Third. Identify the item on the illustration and note the illustration figure and item number of the item.

(4) Fourth. Using the Repair Parts Listing, find the figure and item number noted on the illustration.

b. When National stock number or part number is known.

(1) First. Using the Index of National Stock Numbers and Part Numbers, find the pertinent National stock number or part number. This index is in NIIN sequence followed by a list of part numbers in alphameric sequence, cross-referenced to the illustration figure number and item number.

(2) Second. After finding the figure and item number, locate the figure and item number in the repair parts list.

6. Abbreviations

Not applicable.

(Next printed page is 4)

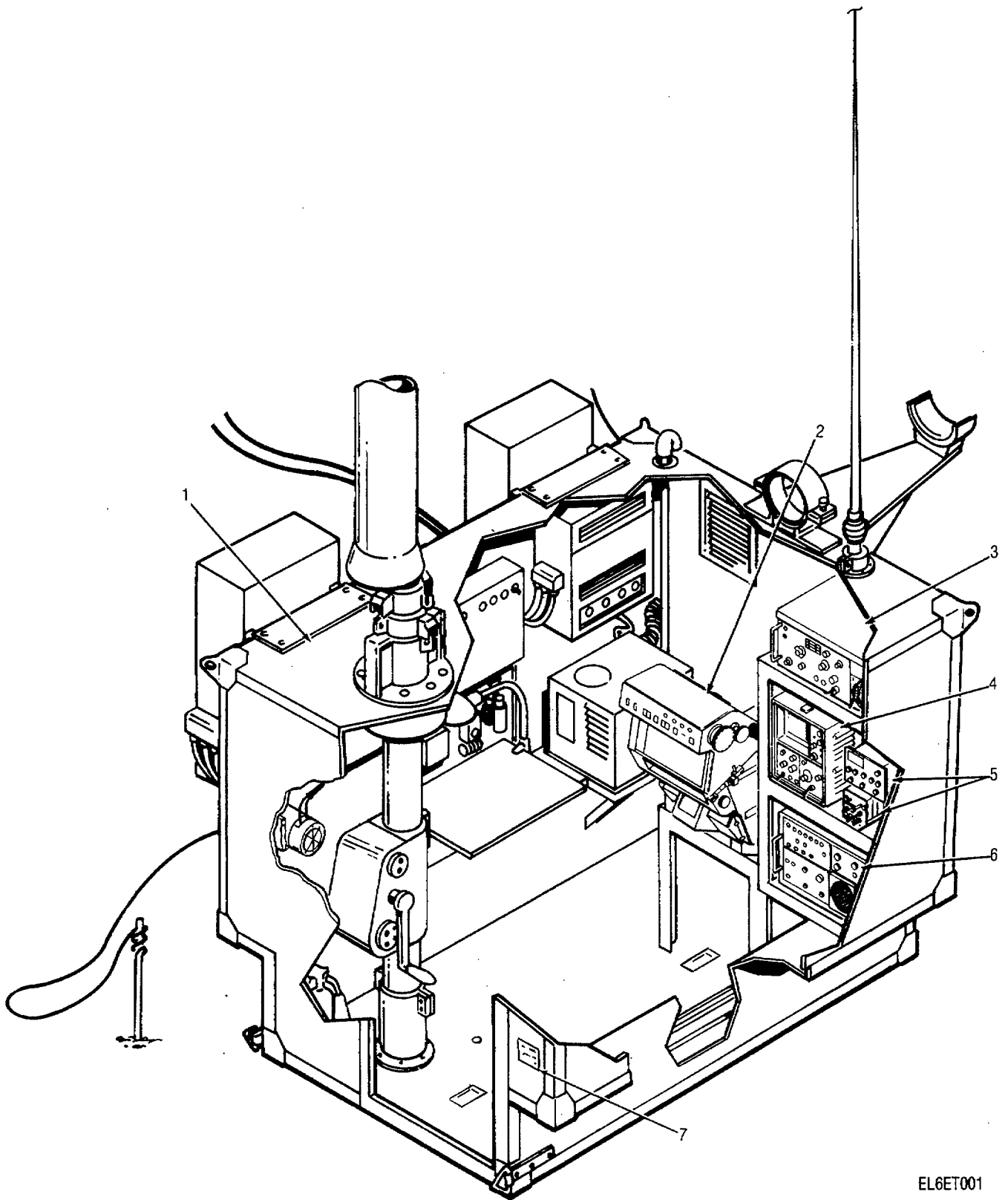

EL6ET001

Figure 1. Receiving Set, Radar Data AN/TKQ-2B

SECTION II

TM 11-5840-361-20P

(1) ILLUSTRATION		(2)	(3)	(4)	(5)	(6)	(7)	(8)
(a) FIG NO.	(b) ITEM NO.	SMR CODE	NATIONAL STOCK NUMBER	PART NUMBER	FSCM	DESCRIPTION USABLE ON CODE	U/M	QTY INC IN UNIT
						GROUP 00 RECEIVING SET, RADAR DATA AN/TKQ-2B		
1	1	PAODD	5411-01-072-0562	S-606/TKQ-2B	80058	SHELTER, ELECTRICAL	EA	1
1	5	PAODD	5821-01-071-5624	AN/ARC-164(V)12	80058	RADIO SET	EA	1

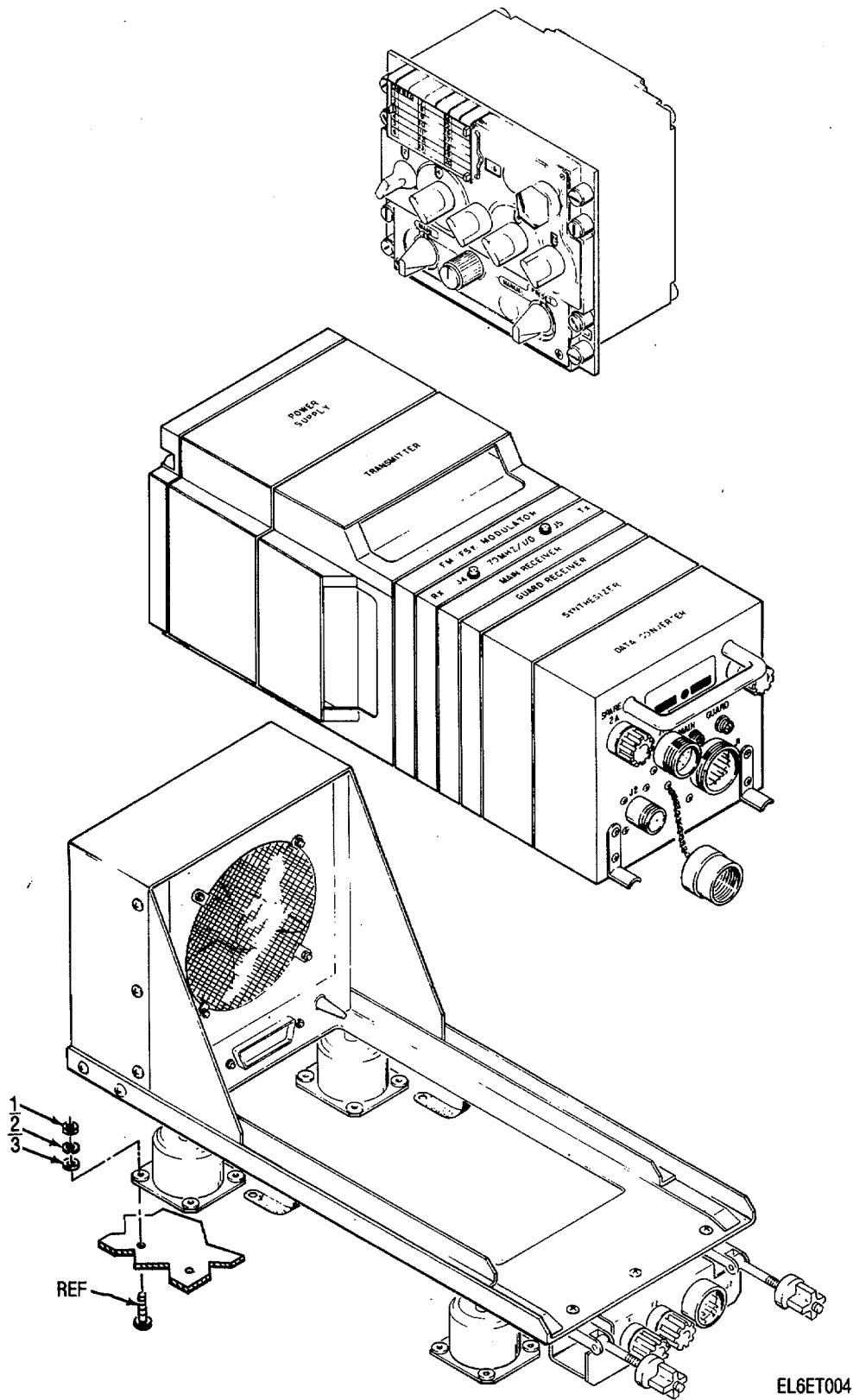
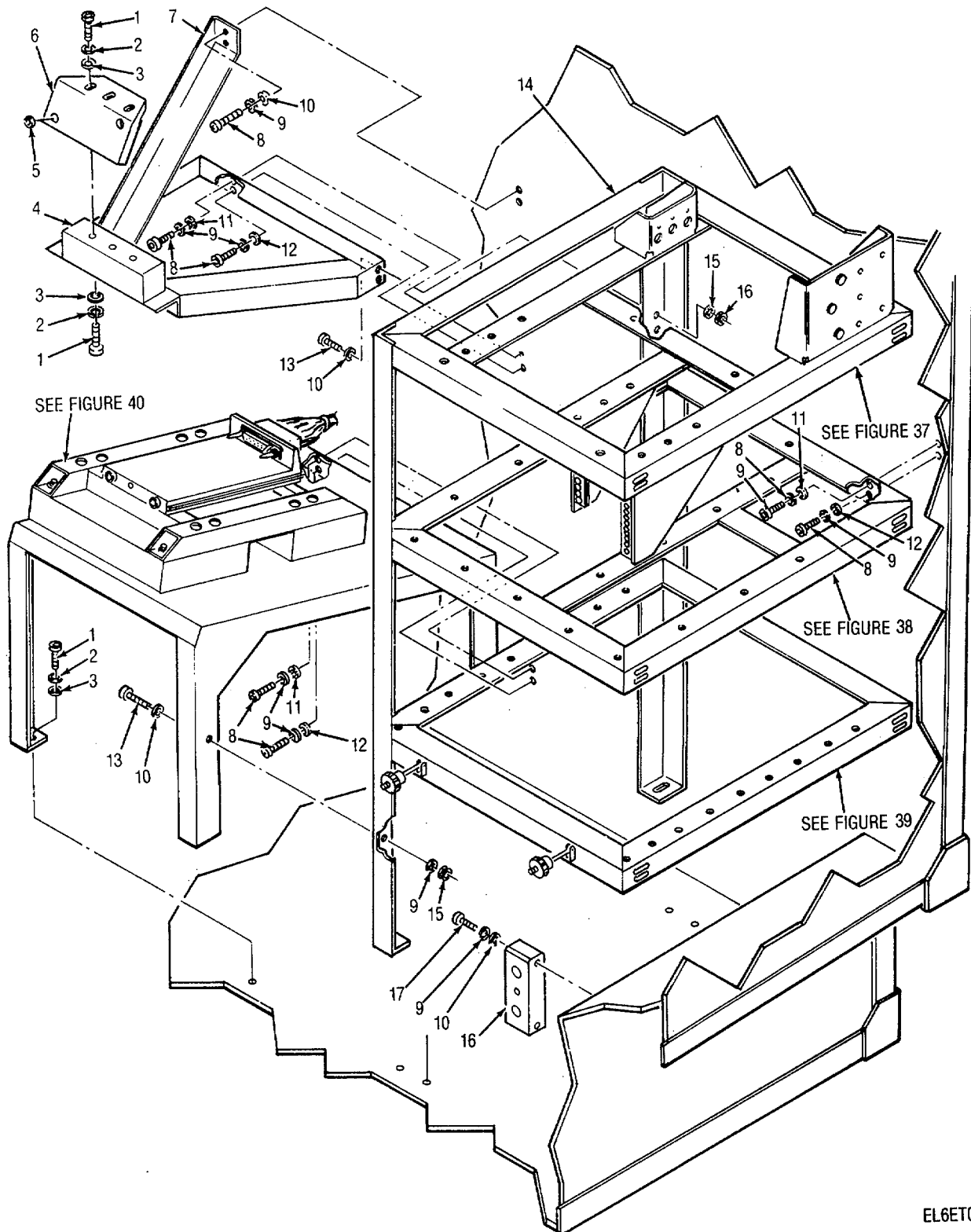

Figure 2. Radio Set AN/ARC-164(V)12

SECTION II

TM 11-5840-361-20P

(1) ILLUSTRATION		(2)	(3)	(4)	(5)	(6)	(7)	(8)
(a) FIG NO.	(b) ITEM NO.	SMR CODE	NATIONAL STOCK NUMBER	PART NUMBER	FSCM	DESCRIPTION USABLE ON CODE	U/M	QTY INC IN UNIT
						GROUP 01 RADIO SET AN/ARC-164(V)12		
2	1	XDOZZ	5310-00-934-9757	MS35649-282	96906	NUT, PLAIN, HEXAGON	EA	16
2	2	XDOZZ	5310-00-045-3299	MS35338-42	96906	WASHER, LOCK	EA	16
2	3	XDOZZ	5310-00-809-8544	MS27183-7	96906	WASHER, FLAT	EA	16



EL6ET055

Figure 35. Shelter Cabinet Installation

SECTION II

TM 11-5840-361-20P

(1) ILLUSTRATION		(2)	(3)	(4)	(5)	(6)	(7)	(8)
(a) FIG NO.	(b) ITEM NO.	SMR CODE	NATIONAL STOCK NUMBER	PART NUMBER	FSCM	DESCRIPTION USABLE ON CODE	U/M	QTY INC IN UNIT
						GROUP 03 SHELTER ELECTRICAL ASSEMBLY S-606/TKQ-2B		
35	4	XDODD		SM-C-942853	80063	SUPPORT, ELEC EQPT.....	EA	1
35	7	XDOZZ		SM-D-942833	80063	SUPPORT, ELEC EQPT	EA	1
35	8	XDOZZ	5305-00-983-6654	MS16998-31	96906	SCREW, CAP, SOCKET HE	EA	4
35	9	XDOZZ	5310-00-045-3296	MS35338-43	96906	WASHER, LOCK.....	EA	6
35	11	XDOZZ		SM-B-943011	80063	WASHER, FLAT	EA	6
35	12	XDOZZ		SM-B-943010	80063	WASHER, FLAT	EA	6
35	13	XDOZZ	5305-00-983-6652	MS16998-29	96906	SCREW, CAP, SOCKET HE	EA	6
35	14	XDODD		SM-D-942287	80063	CABINET, ELEC EQPT	EA	1
35	15	XDOZZ	5310-00-934-9751	MS35650-302	96906	NUT, PLAIN, HEXAGON.....	EA	2
35	16	XDODD		SM-D-943009	80063	SUPPORT, ELEC EQPT	EA	1
35	17	XDOZZ		NAS1315-3-4P	80205	SCREW, MACHINE	EA	2

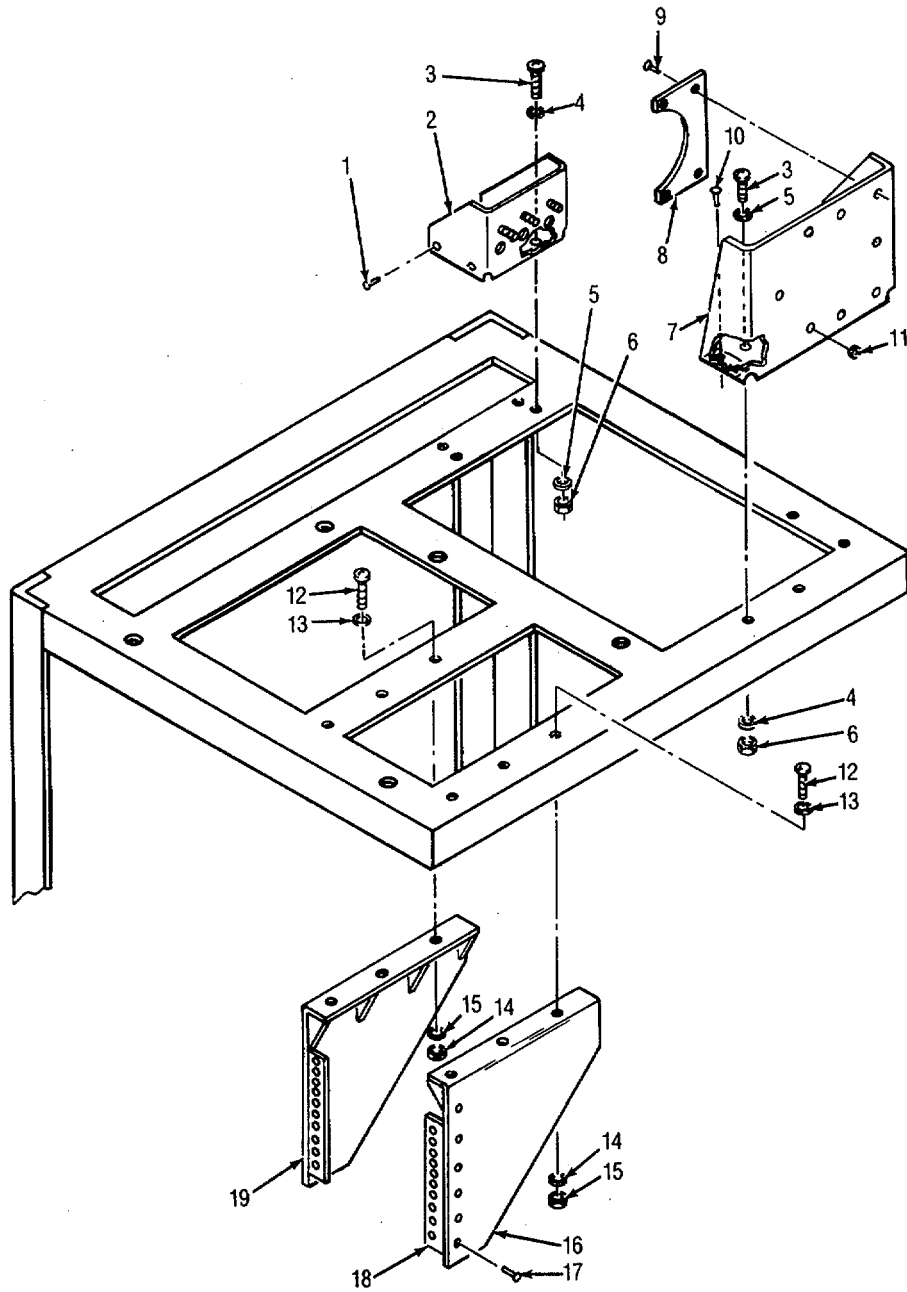

EL6ET056

Figure 36. Shelter Cabinet Top Rack Detail

SECTION II

TM 11-5840-361-20P

(1) ILLUSTRATION		(2)	(3)	(4)	(5)	(6)	(7)	(8)
(a) FIG NO.	(b) ITEM NO.	SMR CODE	NATIONAL STOCK NUMBER	PART NUMBER	FSCM	DESCRIPTION USABLE ON CODE	U/M	QTY INC IN UNIT
36	2	XDODD		SM-D-942978	80063	BRACKET, DBL ANGLE	EA	1
36	3	XDOZZ	5305-00-978-9371	MS16997-33	96906	SCREW, CAP, SOCKET HE	EA	4
36	4	XDOZZ	5310-00-045-3299	MS35338-42	96906	WASHER, LOCK.....	EA	4
36	5	XDOZZ	5310-00-809-8544	MS27183-7	96906	WASHER, FLAT	EA	8
36	6	XDOZZ	5310-00-934-9757	MS35649-282	96906	NUT, PLAIN, HEXAGON.....	EA	4
36	7	XDODD		SM-D-942926	80063	CLAMP, RIM CLINCHING	EA	1
36	11	XDOZZ	5310-00-419-4608	MS3214-9	96906	NUT, PLAIN, CLINCH	EA	3
36	12	XDOZZ		MS24671-15	96906	SCREW, CAP, SOCKET HE	EA	3
36	13	XDOZZ	5310-00-880-5978	MS15795-807	96906	WASHER, FLAT... ..	EA	3
36	14	XDOZZ		MS51848-48	96906	WASHER, LOCK	EA	3
36	15	XDOZZ	5310-00-934-9759	MS35649-284	96906	NUT, PLAIN, HEXAGON	EA	3
36	16	XDODD		SM-D-942937-1	80063	BRACKET, COMP MTG	EA	1
36	19	XDODD		SM-D-942937-2	80063	BRACKET, COMP MTG.....	EA	1

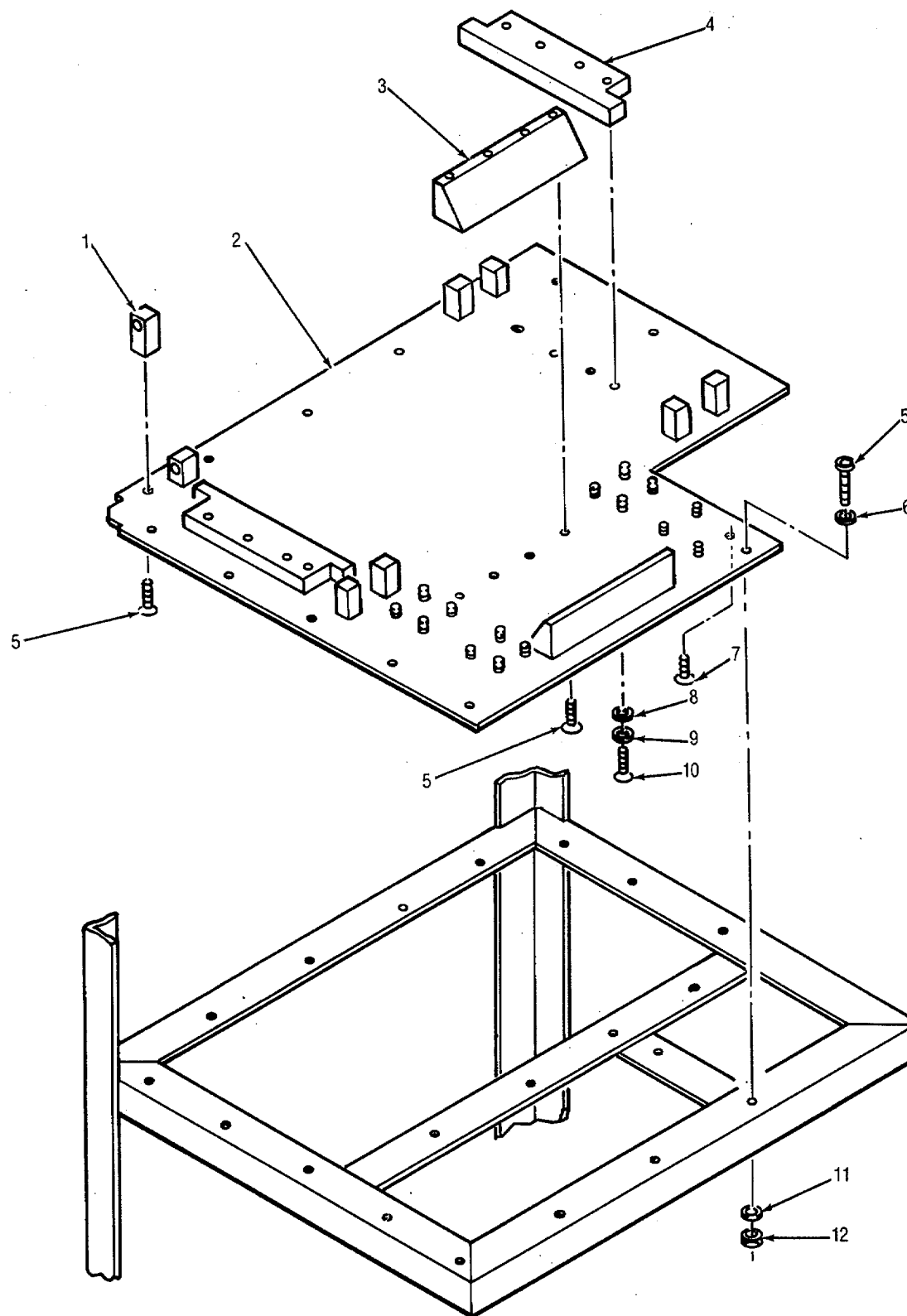

EL6ET057

Figure 37. Shelter Cabinet Middle Rack Detail

SECTION II

TM 11-5840-361-20P

(1) ILLUSTRATION		(2)	(3)	(4)	(5)	(6)	(7)	(8)
(a) FIG NO.	(b) ITEM NO.	SMR CODE	NATIONAL STOCK NUMBER	PART NUMBER	FSCM	DESCRIPTION USABLE ON CODE	U/M	QTY INC IN UNIT
37	1	XDOZZ		SM-C-942885	80063	POST, ELEC-MECH EQPT	EA	8
37	2	XDODD		SM-D-942900	80063	PLATE, MOUNTING.....	EA	1
37	3	XDOZZ		SM-D-942905	80063	SUPPORT, ELEC EQPT.....	EA	2
37	4	XDOZZ		SM-D-942873	80063	SUPPORT, SCOPE	EA	2
37	5	XDOZZ		MS24671-15	96906	SCREW, CAP, SOCKET HE	EA	20
37	6	XDOZZ	5310-00-880-5978	MS15795-807	96906	WASHER, FLAT	EA	20
37	7	XDOZZ		SM-A-942656-1	80063	STUD, SELF-LOCKING	EA	16
37	8	XDOZZ	5310-00-809-8544	MS27183-7	96906	WASHER, FLAT	EA	8
37	9	XDOZZ	5310-00-045-3299	MS35338-42	96906	WASHER, LOCK	EA	8
37	10	XDOZZ	5305-00-978-9372	MS16997-34	96906	SCREW, CAP, SOCKET HE	EA	8
37	11	XDOZZ		MS51848-48	96906	WASHER, LOCK	EA	20
37	12	XDOZZ	5310-00-934-9759	MS35649-284	96906	NUT, PLAIN, HEXAGON	EA	20

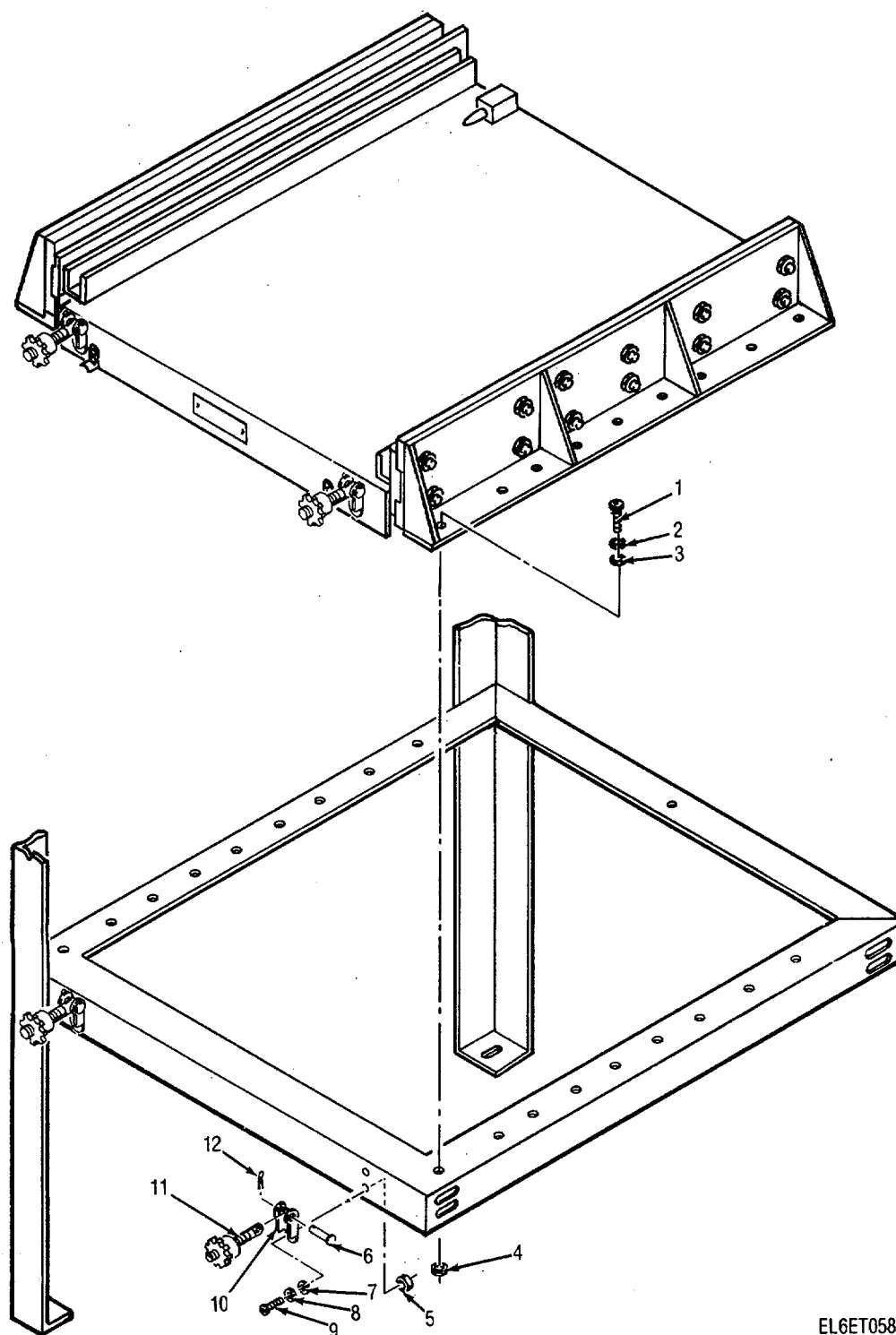

EL6ET058

Figure 38. Shelter Cabinet Lower Rack Detail

SECTION II

TM 11-5840-361-20P

(1) ILLUSTRATION		(2)	(3)	(4)	(5)	(6)	(7)	(8)
(a) FIG NO.	(b) ITEM NO.	SMR CODE	NATIONAL STOCK NUMBER	PART NUMBER	FSCM	DESCRIPTION USABLE ON CODE	U/M	QTY INC IN UNIT
38	1	XDOZZ	5315-00-619-7158	MS9245-25	96906	PIN, COTTER	EA	2
38	2	XDOZZ		MS14108-1	96906	BOLT ASSEMBLY, CLAMP.....	EA	2
38	3	XDOZZ		SM-A-942722-1	80063	CLEVIS, ROD, END	EA	2
38	4	XDOZZ	5305-00-978-9344	MS16997-12	96906	SCREW, CAP, SOCKET HE	EA	4
38	5	XDOZZ	5310-00-543-2410	MS35338-40	96906	WASHER, LOCK	EA	4
38	6	XDOZZ	5310-00-951-4679	MS27183-3	96906	WASHER, FLAT	EA	4
38	7	XDOZZ		MS9463-08	96906	PIN, STRAIGHT, HEADED	EA	2
38	8	XDOZZ	5310-00-934-9739	MS35649-242	96906	NUT, PLAIN, HEXAGO	EA	4
38	9	XDOZZ	5305-00-978-9369	MS16997-31	96906	SCREW, CAP, SOCKET HE	EA	18
38	10	XDOZZ	5310-00-045-3299	MS35338-42	96906	WASHER, LOCK.....	EA	18
38	11	XDOZZ	5310-00-809-8544	MS27183-7	96906	WASHER, FLAT	EA	18
38	12	XDOZZ	5310-00-809-8546	MS27183-8	96906	WASHER, FLAT	EA	12

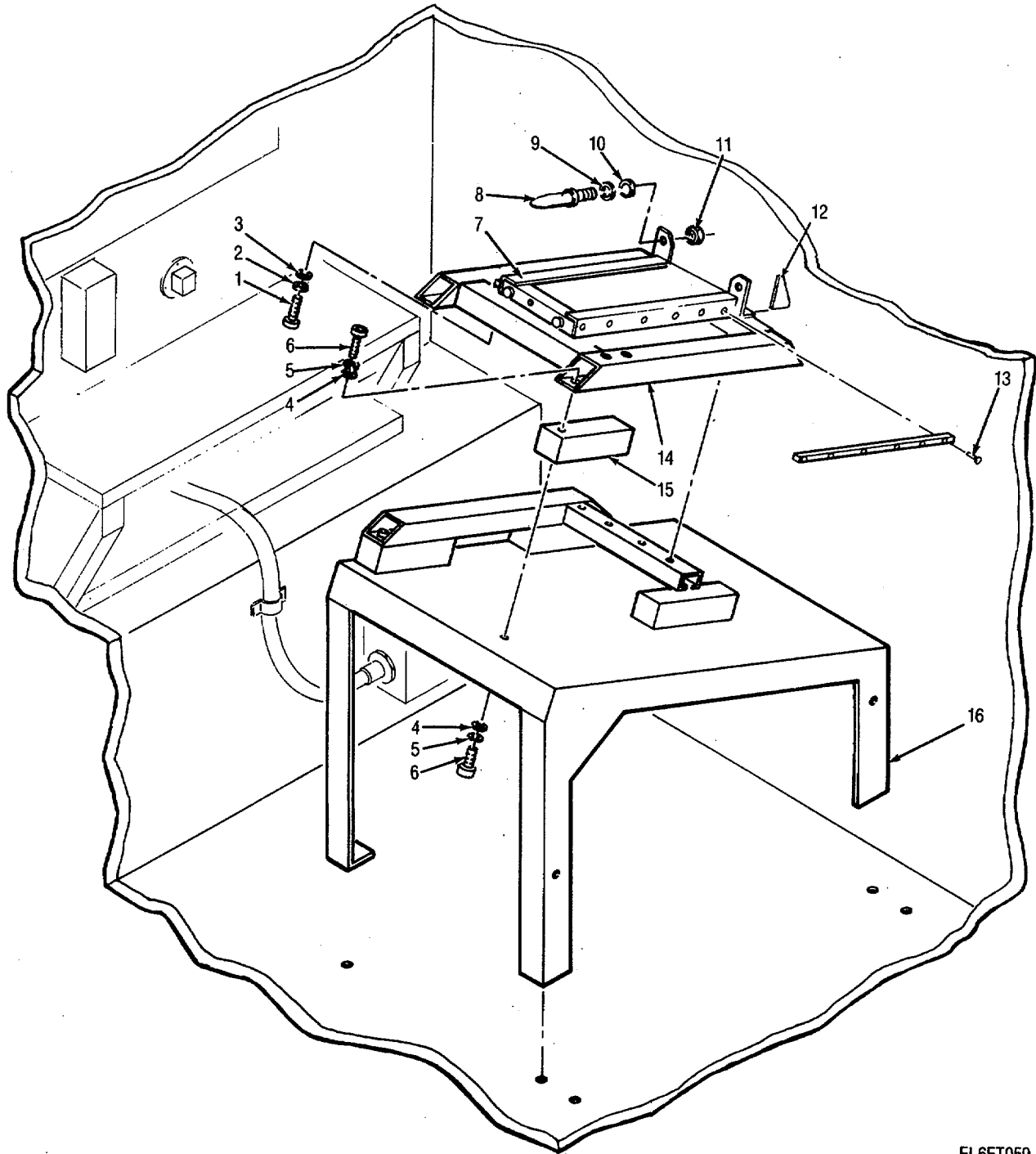

EL6ET059

Figure 39. Shelter Recorder-Processor-Viewer Rack Detail

SECTION II

TM 11-5840-361-20P

(1) ILLUSTRATION		(2)	(3)	(4)	(5)	(6)	(7)	(8)
(a) FIG NO.	(b) ITEM NO.	SMR CODE	NATIONAL STOCK NUMBER	PART NUMBER	FSCM	DESCRIPTION USABLE ON CODE	U/M	QTY INC IN UNIT
39	1	XDOZZ	5305-00-983-7429	MS16998-28	96906	SCREW, CAP, SOCKET HE	EA	6
39	2	XDOZZ	5310-00-045-3296	MS35338-43	96906	WASHER, LOCK	EA	6
39	3	XDOZZ	5310-00-809-8546	MS27183-8	96906	WASHER, FLAT	EA	6
39	4	XDOZZ	5310-00-823-8804	MS27183-9	96906	WASHER, FLAT	EA	12
39	5	XDOZZ	5305-00-983-6660	MS16998-43	96906	SCREW, CAP, SOCKET HE	EA	12
39	6	XDOZZ	5310-00-582-5965	MS35338-44	96906	WASHER, LOCK	EA	12
39	7	XDODD		SM-D-942943	80063	BRACKET, CMPNT MTG	EA	1
39	8	XDOZZ		SM-C-701725	80063	PIN SHLDR THD.....	EA	2
39	9	XDOZZ	5310-00-625-5756	MS15795-812	96906	WASHER, FLAT	EA	2
39	10	XDOZZ	5310-00-974-6623	MS35338-140	96906	WASHER, LOCK.....	EA	2
39	11	XDOZZ	5310-00-939-2655	MS51972-2	96906	NUT, PLAIN, HEXAGON.....	EA	2
39	14	XDOZZ		SM-D-942856	80063	SUPPORT, ELEC SHEL T	EA	1
39	15	XDOZZ		SM-C-942854	80063	SUPPORT, ELEC EQPT	EA	4
39	16	XDOZZ		SM-D-942898	80063	SUPPORT, ELEC EQPT	EA	1

STOCK NUMBER	FIGURE NO.	ITEM NO.	STOCK NUMBER	FIGURE NO.	ITEM NO.
5310-00-045-3296	35	9	5310-00-934-9739	38	8
5310-00-045-3296	39	2	5310-00-934-9751	35	15
5310-00-045-3299	2	2	5310-00-934-9757	2	1
5310-00-045-3299	36	4	5310-00-934-9757	36	6
5310-00-045-3299	37	9	5310-00-934-9759	36	15
5310-00-045-3299	38	10	5310-00-934-9759	37	12
5310-00-419-4608	36	11	5310-00-939-2655	39	11
5310-00-543-2410	38	5	5310-00-951-4679	38	6
5310-00-582-5965	39	6	5310-00-974-6623	39	10
5315-00-619-7158	38	1	5305-00-978-9344	38	4
5310-00-625-5756	39	9	5305-00-978-9369	38	9
5310-00-809-8544	2	3	5305-00-978-9371	36	3
5310-00-809-8544	36	5	5305-00-978-9372	37	10
5310-00-809-8544	37	8	5305-00-983-6652	35	13
5310-00-809-8544	38	11	5305-00-983-6654	35	8
5310-00-809-8546	38	12	5305-00-983-6660	39	5
5310-00-809-8546	39	3	5305-00-983-7429	39	1
5310-00-823-8804	39	4			
5310-00-880-5978	36	13	5821-01-071-5624	1	5
5310-00-880-5978	37	6	5411-01-072-0562	1	1

PART NUMBER	FSCM	FIGURE NO.	ITEM NO.	PART NUMBER	FSCM	FIGURE NO.	ITEM NO.
AN/ARC-164(V)12	80058	1	5	MS35649-282	96906	36	6
MS14108-1	96906	38	2	MS35649-284	96906	36	15
M515795-807	96906	36	13	MS35649-284	96906	37	12
M515795-807	96906	37	6	M535650-302	96906	35	15
MS15795-812	96906	39	9	M551848-48	96906	36	14
MS16997-12	96906	38	4	M551848-48	96906	37	11
MS16997-31	96906	38	9	MS51972-2	96906	39	11
MS16997-33	96906	36	3	MS9245-25	96906	38	1
MS16997-34	96906	37	10	MS9463-08	96906	38	7
MS16998-28	96906	39	1	S-606/TKQ-2B	80058	1	1
MS16998-29	96906	35	13	SM-A-942656-1	80063	37	7
MS16998-31	96906	35	8	SM-A-942722-1	80063	38	3
MS16998-43	96906	39	5				
MS24671-15	96906	36	12				
M524671-15	96906	37	5				

M527183-3	96906	38	6	SM-B-943010	80063	35	12
MS27183-7	96906	2	3	SM-B-943011	80063	35	11
M527183-7	96906	36	5	SM-C-701725	80063	39	8
M527183-7	96906	37	8	SM-C-942853	80063	35	4
M527183-7	96906	38	11	SM-C-942854	80063	39	15
M527183-8	96906	38	12	SM-C-942885	80063	37	1
M527183-8	96906	39	3	SM-D-942287	80063	35	14
MS27183-9	96906	39	4	SM-D-942833	80063	35	7
MS3214-9	96906	36	11	SM-D-942856	80063	39	14
M535338-140	96906	39	10	SM-D-942873	80063	37	4
MS35338-40	96906	38	5	SM-D-942898	80063	39	16
MS35338-42	96906	2	2	SM-D-942900	80063	37	2
MS35338-42	96906	36	4	SM-D-942905	80063	37	3
MS35338-42	96906	37	9	SM-D-942926	80063	36	7
MS35338-42	96906	38	10	SM-D-942937-1	80063	36	16
MS35338-43	96906	35	9	SM-D-942937-2	80063	36	19
MS35338-43	96906	39	2	SM-D-942943	80063	39	7
MS35338-44	96906	39	6	SM-D-942978	80063	36	2
MS35649-242	96906	38	8	SM-D-943009	80063	35	16
MS35649-282	96906	2	1	NAS1315-3-4P	80205	35	17

By Order of the Secretary of the Army:

Official:

J. C. PENNINGTON
Major General, United States Army
The Adjutant General

E. C. MEYER
General, United States Army
Chief of Staff

Distribution:

To be distributed in accordance with DA Form 12-36 Organizational maintenance requirements for AN/TKO-2.

RECOMMENDED CHANGES TO EQUIPMENT TECHNICAL PUBLICATIONS



THEN...JOT DOWN THE
DOPE ABOUT IT ON THIS FORM.
CAREFULLY TEAR IT OUT, FOLD IT
AND DROP IT IN THE MAIL.

SOMETHING WRONG WITH PUBLICATION

FROM: (PRINT YOUR UNIT'S COMPLETE ADDRESS)

DATE SENT

PUBLICATION NUMBER

PUBLICATION DATE

PUBLICATION TITLE

BE EXACT PIN-POINT WHERE IT IS

PAGE NO.	PARA-GRAPH	FIGURE NO.	TABLE NO.

IN THIS SPACE, TELL WHAT IS WRONG
AND WHAT SHOULD BE DONE ABOUT IT.

TEAR ALONG PERFORATED LINE

PRINTED NAME, GRADE OR TITLE AND TELEPHONE NUMBER

SIGN HERE

